

REFERENCE ONLY

ABOVE GROUND GEAR w/HANDWHEEL

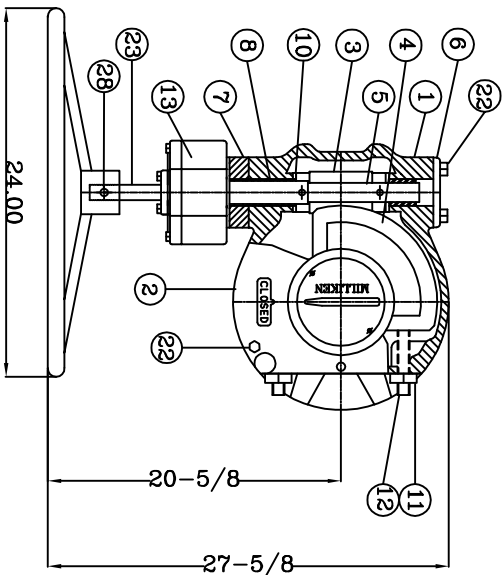

BURIED SERVICE GEAR w/2" NUT

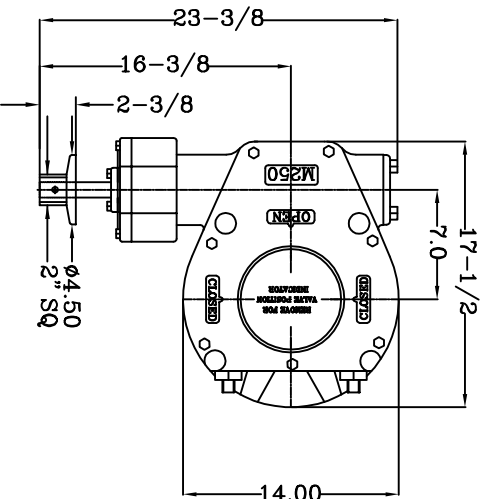

SPUR GEAR

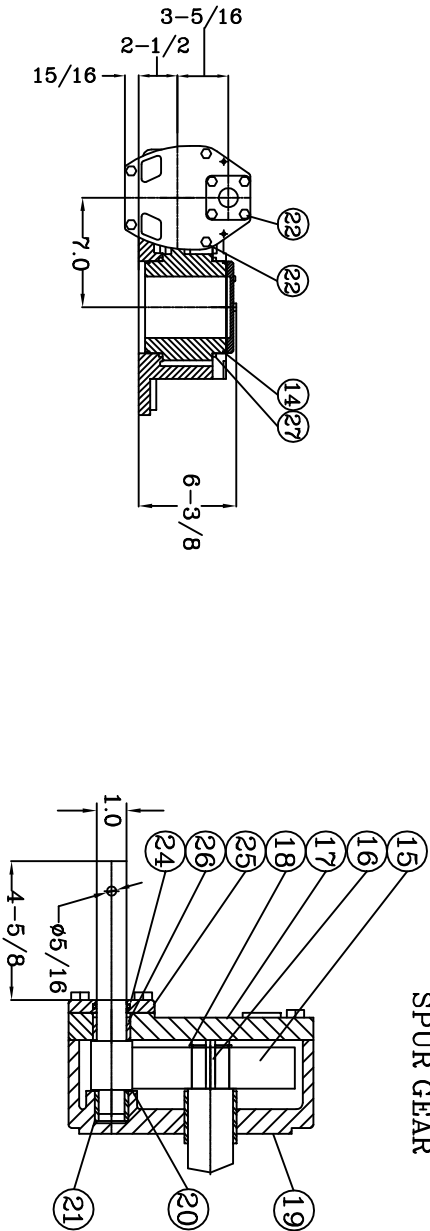

THIS DRAWING IS THE PROPERTY OF
HENRY PRATT COMPANY
AND MUST NOT BE USED IN ANY WAY
PREJUDICIAL TO THEIR INTERESTS

ITEM	QTY	DESCRIPTION	MATERIAL	DESIGNATION
28	1	SPRING PIN	SPRING STEEL	-
27	2	BEARING	BRONZE	ASTM B438
26	1	BEARING	BRONZE	ASTM B438
25	1	COVER	DUCTILE IRON	ASTM A536 Gr. 65-45-12
24	1	O-RING	BUNA-N	-
23	1	GEAR STEM	STEEL	SAE 1045
22	AR	COVER SCREW	STEEL/ZINC	-
21	1	BEARING	BRONZE	ASTM B438
20	1	WASHER	STEEL	-
19	1	S5 HOUSING	DUCTILE IRON	ASTM A536 Gr. 65-45-12
18	1	RING	STEEL	-
17	1	S5 COVER	DUCTILE IRON	ASTM A536 Gr. 65-45-12
16	1	KEY	STEEL	SAE 1045
15	1	GEAR	STEEL	-
14	2	O-RING	BUNA-N	-
13	1	SPUR GEAR	DUCTILE IRON	ASTM A536 Gr. 65-45-12
12	2	STOP LUG STUD	STEEL/ZINC	-
11	2	HEX NUT	STEEL	-
10	2	BEARING	STEEL	-
8	5	BEARING	BRONZE	ASTM B438
7	1	SPACER	DUCTILE IRON	ASTM A536 Gr. 65-45-12
6	1	SIDE COVER	DUCTILE IRON	ASTM A536 Gr. 65-45-12
5	1	SHAFT	STEEL	SAE 1045
4	1	GEAR	DUCTILE IRON	ASTM A536 Gr. 100-70-3
3	1	WORM GEAR	STEEL	SAE 4115
2	1	COVER	DUCTILE IRON	ASTM A536 Gr. 65-45-12
1	1	HOUSING	DUCTILE IRON	ASTM A536 Gr. 65-45-12

DATE	REVISION	BY	TITLE
1/02/03	REVISED TITLE, BLOCK LETTERS	JC	HENRY PRATT GEAR
2/12/03	ADDED NO. OF TURNS	JC	TYPE: M250
3/04/03	WEIGHT CHANGED FROM 159 LBS. TO 225 LBS.	JC	24" & 30" PV STD. PORT
			24" PV-100% PORT

ISSUE NUMBER	1
DATE	09/21/09
BY	JC
CHKD. BY	AJ
SCALE	NONE
DWG. NO.	HP 496625

APPRX. WEIGHT: 225 LB. No. OF TURNS: 62-1/2