

ACTUATOR POSITION 1

INPUT ROTATION OPEN LEFT (OL) UNLESS OTHERWISE NOTED.

F = NO. & SIZE OF BOLTS  
 125# STANDARD LAYOUT  
 STRADDLE CENTERLINE  
 INCLUDES TAPPED HOLES  
 EACH FLANGE



TAPPED HOLES "F" UNC 2B X E DEEP  
 VALVE NO. TAPPED HOLES  
 SIZE (EACH FLANGE)  
 3"-16" ALL THRU HOLES  
 18" & 20" 2-TOP; 2-BOTTOM

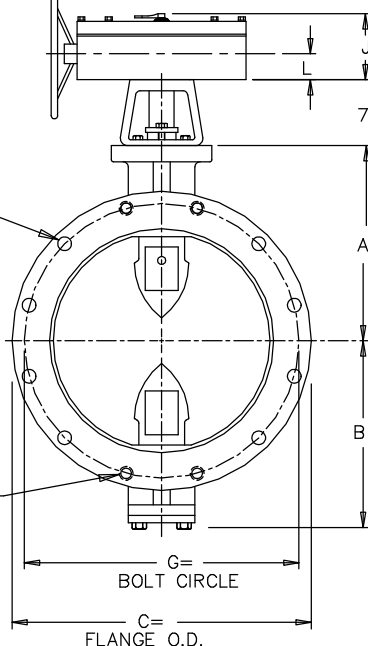

NOTES:

1. ALL DIMENSIONS SHOWN IN INCHES.
2. "D" DIMENSION  $\pm 1/16"$  FOR 3" THRU 10" VALVES.  
 "D" DIMENSION  $\pm 1/8"$  FOR 12" THRU 20" VALVES.
3. FOR BOLTS SMALLER THAN  $\phi 1-3/4$ , BOLT HOLES WILL BE  $1/8"$  LARGER THAN DIAMETER OF BOLT.  
 FOR BOLTS  $\phi 1-3/4$  OR LARGER, BOLT HOLES WILL BE  $1/4"$  LARGER THAN DIAMETER OF BOLT.
4. DIMENSIONS AND DRILLING OF END FLANGES CONFORM TO THE AMERICAN CAST IRON FLANGE STANDARDS, CLASS 125 (B16.1).
5. VALVES MANUFACTURED & TESTED IN ACCORDANCE WITH AWWA SPECIFICATION C-504 LATEST REVISION, CLASS 150B.
6. RECOMMENDATION FOR MATING FLANGES: WHERE INSULATING BUSHINGS ARE USED, IT IS NECESSARY THAT BOLT HOLES BE DRILLED OVERSIZE BY AN AMOUNT EQUAL TO TWO TIMES THE INSULATING SLEEVE THICKNESS TO MAINTAIN THE SAME MINIMUM CLEARANCE FOR BOLTS.

| VALVE SIZE | A      | B      | C      | D | E       | F         | G      |
|------------|--------|--------|--------|---|---------|-----------|--------|
| 3          | 4-3/4  | 3-7/8  | 7-1/2  | 5 | 3/4     | 4--5/8    | 6      |
| 4          | 5-1/2  | 4-1/8  | 9      | 5 | 15/16   | 8--5/8    | 7-1/2  |
| 6          | 6-1/2  | 5-1/8  | 11     | 5 | 1       | 8--3/4    | 9-1/2  |
| 8          | 7-3/4  | 6-1/2  | 13-1/2 | 6 | 1-1/8   | 8--3/4    | 11-3/4 |
| 10         | 9      | 9-7/8  | 16     | 8 | 1-3/16  | 12--7/8   | 14-1/4 |
| 12         | 10-1/2 | 11-3/8 | 19     | 8 | 1-1/4   | 12--7/8   | 17     |
| 14         | 11-7/8 | 12-3/4 | 21     | 8 | 1-3/8   | 12--1     | 18-3/4 |
| 16         | 13-1/2 | 14-3/8 | 23-1/2 | 8 | 1-7/16  | 16--1     | 21-1/4 |
| 18         | 14-3/8 | 15-1/4 | 25     | 8 | 1-9/16  | 16--1-1/8 | 22-3/4 |
| 20         | 16     | 16-7/8 | 27-1/2 | 8 | 1-11/16 | 20--1-1/8 | 25     |

| ACTUATOR SIZE | J       | L       | M     | N      | P      | Q     | R       | S       | T       | V  | W       | NUMBER OF TURNS |
|---------------|---------|---------|-------|--------|--------|-------|---------|---------|---------|----|---------|-----------------|
| MDT-2S        | 4-11/16 | 2       | 2-1/8 | 2      | 4-1/2  | 4-1/4 | 8-1/4   | 7-7/8   | 7-7/8   | 8  | 9-1/8   | 32              |
| MDT-3S        | 5-5/8   | 2-7/16  | 3-1/4 | 3-5/32 | 5-5/8  | 5-3/8 | 10-3/8  | 10-1/2  | 10-1/8  | 12 | 9-1/8   | 30              |
| MDT-4S        | 6-3/8   | 2-27/32 | 3-3/8 | 4      | 7-5/16 | 6-3/4 | 11-5/16 | 11-1/2  | 11      | 12 | 9-1/8   | 40              |
| MDT-5         | 7-9/16  | 3-15/32 | 4-1/2 | 5-1/2  | 8-3/4  | 10    | 17      | 17 3/16 | 17-3/16 | 18 | 16-7/16 | 44              |