

ACTUATOR SIZE	J	L	M	N	P	Q	R	S	T	V	W	NUMBER OF TURNS
MDT-2S	4-11/16	2	2-1/8	2	4-1/2	4-1/4	8-1/4	7-7/8	7-7/8	8/12 (SEE NOTE 7)	9-1/8	32
MDT-3S	5-5/8	2-7/16	3-1/4	3-5/32	5-5/8	5-3/8	10-3/8	10-1/2	10-1/8	12	9-1/8	30
MDT-4S	6-3/8	2-27/32	3-3/8	4	7-5/16	6-3/4	11-5/16	11-1/2	11	12	9-1/8	40
MDT-5	7-9/16	3-15/32	4-1/2	5-1/2	8-3/4	10	17	17 3/16	17-3/16	18	16-7/16	44

VALVE SIZE	A	B	C	D	E	F	G
3	4-3/4	3-1/4	7-1/2	5	13/16	4--5/8	6
4	5-1/2	3-1/2	9	5	1	8--5/8	7-1/2
6	6-1/2	5-1/8	11	5	1-1/16	8--3/4	9-1/2
8	7-3/4	6-1/2	13-1/2	6	1-3/16	8--3/4	11-3/4
10	9	9-7/8	16	8	1-3/16	12--7/8	14-1/4
12	10-1/2	11-3/8	19	8	1-5/16	12--7/8	17
14	11-7/8	12-3/4	21	8	1-3/8	12--1	18-3/4
16	13-1/2	14-3/8	23-1/2	8	1-7/16	16--1	21-1/4
18	14-3/8	15-1/4	25	8	1-9/16	16--1-1/8	22-3/4
20	16	16-7/8	27-1/2	8	1-11/16	20--1-1/8	25

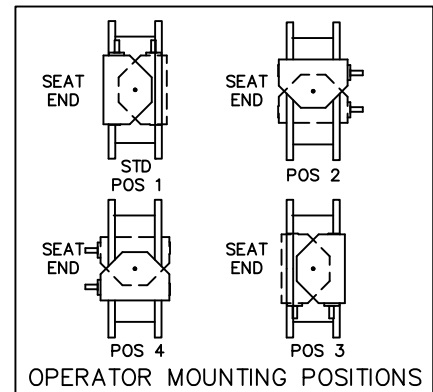

- A. IGNORE SEAT SIDE DESIGNATION ON BFV SIZE 3" -20"
- B. CHECK WITH FACTORY WHEN SELECTING ALTERNATE MIRROR ACTUATOR STYLES.

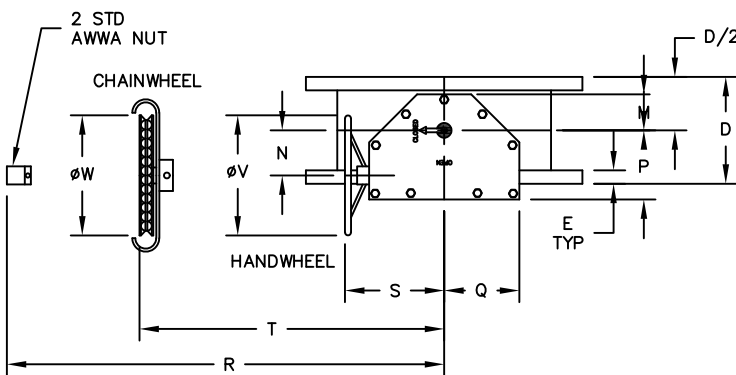

ACTUATOR POSITION 1

NOTE: INPUT ROTATION OPEN LEFT (OL) UNLESS OTHERWISE NOTED.

F = NO. & SIZE OF BOLTS
125# STANDARD LAYOUT
STRADDLE CENTERLINE
INCLUDES TAPPED HOLES
EACH FLANGE

TAPPED HOLES "F" UNC 2B X E DEEP
VALVE NO. TAPPED HOLES
SIZE (EACH FLANGE)
3"-16" ALL THRU HOLES
18" & 20" 2-TOP; 2-BOTTOM

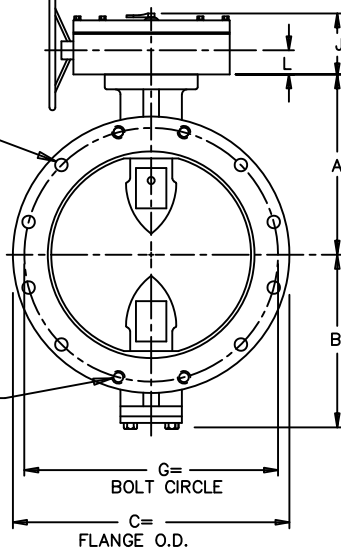

NOTES:

- ALL DIMENSIONS SHOWN IN INCHES.
- "D" DIMENSION $\pm 1/16"$ FOR 3" THRU 10" VALVES.
"D" DIMENSION $\pm 1/8"$ FOR 12" THRU 20" VALVES.
- FOR BOLTS SMALLER THAN $\phi 1-3/4$, BOLT HOLES WILL BE $1/8"$ LARGER THAN DIAMETER OF BOLT.
FOR BOLTS $\phi 1-3/4$ OR LARGER, BOLT HOLES WILL BE $1/4"$ LARGER THAN DIAMETER OF BOLT.
- DIMENSIONS AND DRILLING OF END FLANGES CONFORM TO THE AMERICAN CAST IRON FLANGE STANDARDS, CLASS 125 (B16.1).
- VALVES MANUFACTURED & TESTED IN ACCORDANCE WITH AWWA SPECIFICATION C-504 LATEST REVISION, CLASS 150B.
- RECOMMENDATION FOR MATING FLANGES: WHERE INSULATING BUSHINGS ARE USED, IT IS NECESSARY THAT BOLT HOLES BE DRILLED OVERSIZE BY AN AMOUNT EQUAL TO TWO TIMES THE INSULATING SLEEVE THICKNESS TO MAINTAIN THE SAME MINIMUM CLEARANCE FOR BOLTS.
- 12" HAND WHEEL STANDARD ONLY ON 12" VALVE.

TOLERANCES	
FLANGE THICKNESS "E":	$+1/8"$ -0
LAYING LENGTH "D":	
3" THRU 10"	$\pm 1/16"$
12" THRU 20"	$\pm 1/8"$
BOLT CIRCLE "G":	$\pm 1/64"$
FLANGE O.D. "C":	
3" THRU 10"	$\pm 1/8"$
12" THRU 20"	$\pm 3/16"$

REV	DATE	DESCRIPTION	DWN	APP
2	2/10/22	UPDATED TITLE BLOCK, ADDED NOTE 7 & POS CHART	RTF	RF
1	5/5/11	REV COL B & E & ADDED TOL	JLM	RCB

PRATT
a MUELLER brand

GENERAL ARRANGEMENT DRAWING
3" - 20" FLG BUTTERFLY VALVE
MDT MANUAL ACTUATOR

SCALE NONE DATE 1/20/09
DRAWN BY CEM CHECKED BY JR
APPROVED GA=BORDER
DRWG. NO. GA-11864 REV 2 A/C