

ITEM NO.	DESCRIPTION	MATERIALS
1	BODY	DUCTILE IRON ASTM A-536 (65-45-12)
2	BEARINGS	TEFLON LINED, FIBERGLASS BACKED
3	DISC & EDGE	NICKLE ALUM BRONZE ASTM B-148/505 C-95500
4	N/A	N/A
5	TOP STUB SHAFT	STAINLESS STEEL ASTM A-276 TYPE 316
6	BOTTOM STUB SHAFT	STAINLESS STEEL ASTM A-276 TYPE 316
7	PACKING	RESILOSEAL W (EPDM)
8	BOTTOM COVER	DUCTILE IRON ASTM A-536 (65-45-12)
9	CAP SCREWS	STAINLESS STEEL TYPE 316 STAINLESS STEEL TYPE 304
10	SQUEEZE PINS	STAINLESS STEEL ASTM A-276 TYPE 316
11	KEY	CARBON STEEL AISI 1045
12	THRUST COLLAR	BRONZE ASTM B-505 ALLOY C93200
13	THRUST COLLAR SHIMS	BRASS ALLOY C26000 HALF HARD (H02)
14	SPRING PIN	STAINLESS STEEL TYPE 420
15	O-RING	RUBBER (BUNA N)
16	PACKING RETAINER	NYLON
17	SEAT	RESILOSEAL W (EPDM)

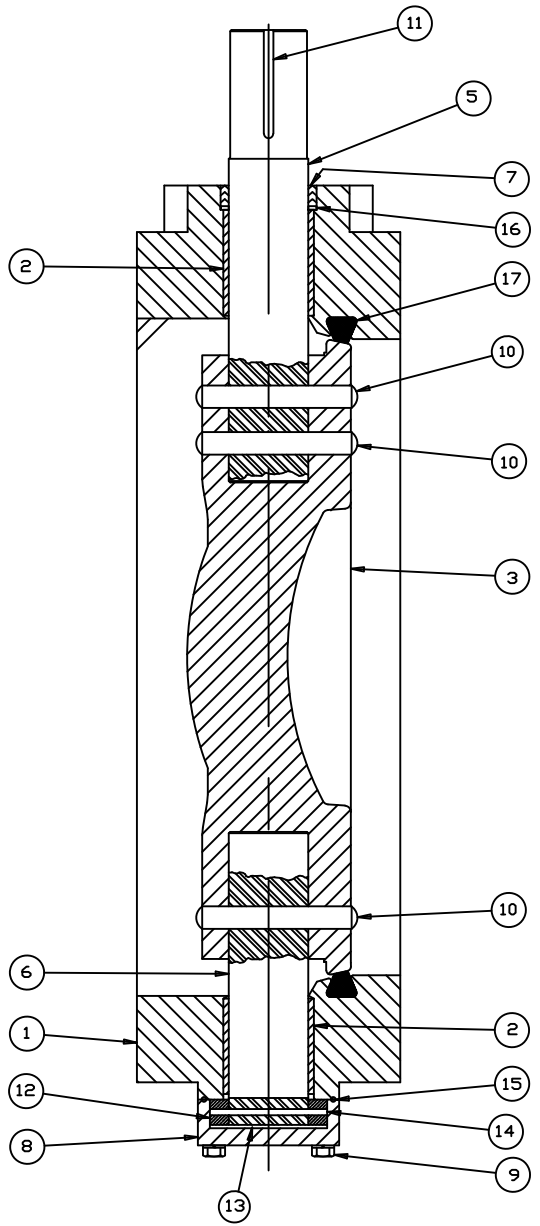

2	6/2/22	ADDED 316SS HARDWARE	RTF	RF
1	4/29/22	REMOVED ITEM 18	RTF	RF
REV	DATE	DESCRIPTION	DWN	APP



CROSS SECTION
PARTS AND MATERIALS LIST
24" TRITON XR BUTTERFLY VALVE
WITH ALUMINUM BRONZE DISC

SCALE NONE DATE 9/22/15
DRAWN BY AMJ CHECKED BY SS
APPROVED GA=BORDER
DRWG. NO. GA-12045 REV 2 A/C