

PRATT®

a **MUELLER** brand

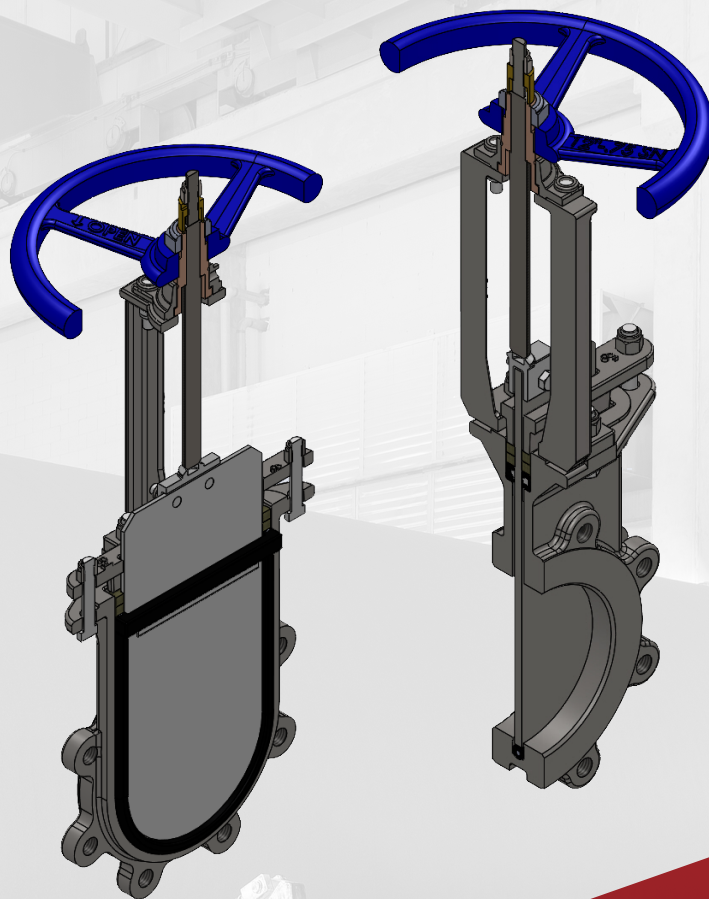

FIGURE P77

Resilient Seated Knife Gate Valve

PRATT®

a **MUELLER** brand

Introducing the revolutionary Pratt® P77 Perimeter Seated Bi-Directional Knife Gate Valve, specifically engineered to handle tough slurries and abrasive materials with ease. Equipped with superb sealing capabilities and built to meet the rigorous MSS-SP-81, AWWA C520-10, and TAPPI-TIS 405-8 standards, the Pratt® Knife Gate Valve is the ultimate solution for a range of applications in industries, including mining, chemical, food/beverage, and pulp and paper.

OVERVIEW



360 degree wrap-around packing with first row elastomer seal



Gate reinforced by a PTFE bearing incorporated into the seat



Seat loads into the body through the packing chamber

KEY FEATURES AND BENEFITS

- Enables drip-tight shut off regardless of line pressure and prevents buildup
- Eliminates confusion on the direction of isolation
- Gate is guided through the cycle, reducing stress on the packing chamber
- Reduces leak paths and extends the life of the packing
- Tightening of the packing creates hoop strength in the metal bar enclosed in the seat – preventing the seat from pulling out or rolling

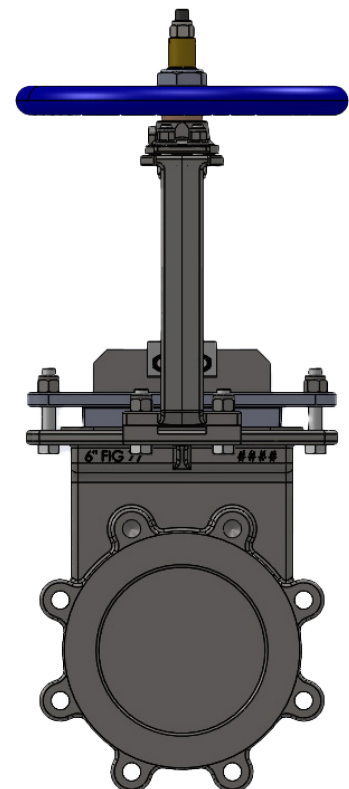

P77 KNIFE GATE VALVE CONSTRUCTION

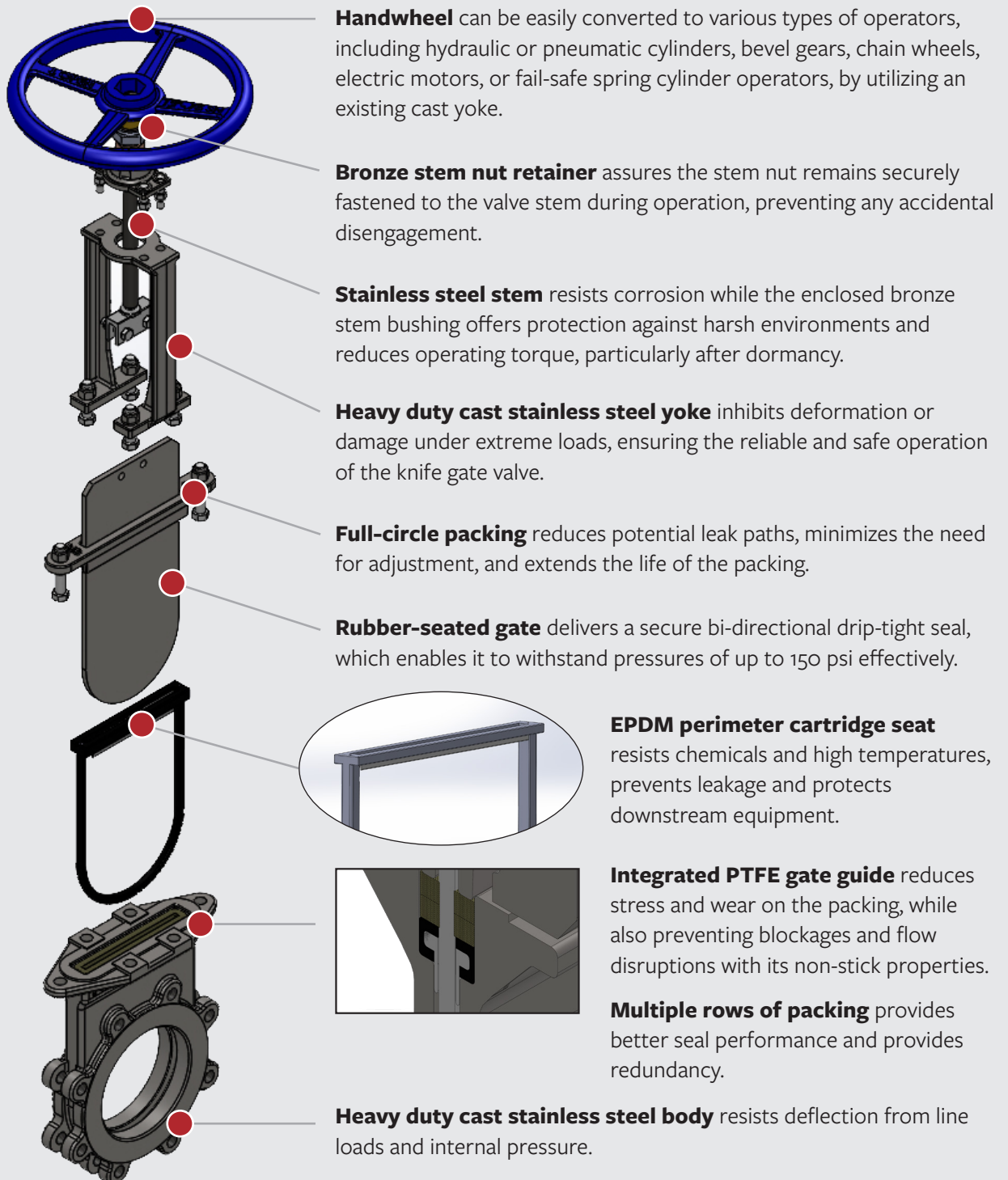

Handwheel can be easily converted to various types of operators, including hydraulic or pneumatic cylinders, bevel gears, chain wheels, electric motors, or fail-safe spring cylinder operators, by utilizing an existing cast yoke.

Bronze stem nut retainer assures the stem nut remains securely fastened to the valve stem during operation, preventing any accidental disengagement.

Stainless steel stem resists corrosion while the enclosed bronze stem bushing offers protection against harsh environments and reduces operating torque, particularly after dormancy.

Heavy duty cast stainless steel yoke inhibits deformation or damage under extreme loads, ensuring the reliable and safe operation of the knife gate valve.

Full-circle packing reduces potential leak paths, minimizes the need for adjustment, and extends the life of the packing.

Rubber-seated gate delivers a secure bi-directional drip-tight seal, which enables it to withstand pressures of up to 150 psi effectively.

EPDM perimeter cartridge seat resists chemicals and high temperatures, prevents leakage and protects downstream equipment.

Integrated PTFE gate guide reduces stress and wear on the packing, while also preventing blockages and flow disruptions with its non-stick properties.

Multiple rows of packing provides better seal performance and provides redundancy.

Heavy duty cast stainless steel body resists deflection from line loads and internal pressure.

P77 KNIFE GATE VALVE APPLICATIONS



APPLICATION

- Pulp and Paper
- Drilling
- Water and Wastewater
- Food and Beverage



TECHNICAL DATA

- Size range: 2" -24"
- Temperature rating: -65 °F – 300°F
- Pressure rating: up to 150 psi as required by MSS SP-81
- End connection: Wafer
- Flange Drilling: ANSI B16.5



INDUSTRY STANDARDS

- MSS SP-81
- TAPPI TIS 405-8
- AWWA C520-10



Experience Pratt[®] P77 Knife Gate Valve's superior performance and reliability.

To learn more, scan the QR code or go to <https://marketing.muellerwp.com/PrattP77>

For more information about us or to view our full line of water products, please visit www.prattvalve.com or call Pratt customer service at 1.800.423.1323.

Mueller refers to one or more of Mueller Water Products, Inc., a Delaware corporation ("MWP"), and its subsidiaries. MWP and each of subsidiaries are legally separate and independent entities when providing products and services. MWP does not provide products or services to third parties. MWP and each of its subsidiaries are liable only for their own acts and omissions and not those of each other. MWP brands include Mueller[®], Echologics[®], Hydro Gate[®], Hydro-Guard[®], HYMAX[®], i2O[®], Jones[®], Mi.Net[®], Milliken[®], Pratt[®], Pratt Industrial[®], Singer[®], Sentryx[™], and U.S. Pipe Valve & Hydrant. Please see www.muellerwp.com/about to learn more.

©2023 Henry Pratt Company, LLC. All Rights Reserved. The trademarks, logos and service marks displayed in this document are the property of Henry Pratt Company, LLC, its affiliates or other third parties. Products marked with a section symbol (§) are subject to patents or patent applications. For details, visit www.mwppat.com. These products are intended for use in potable water applications. Please contact your Pratt Sales or Customer Service Representative concerning any other application(§).